

TP/R-PR-AS

PNEUMATIC AUTOMATIC CUTTING
FORMING MACHINE FOR TAPED RADIAL
COMPONENTS

EXAMPLES OF FORMS



90.OL11 110 V

90.OL12 220 V

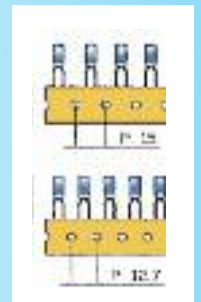

The model TP/R-PR is a pneumatic machine with foot pedal control designed for cutting and forming taped radial components. The die assembly "SMS" is equipped with a wire holder to keep the leads firm in position during the machine operation avoiding any stress or damage to the part. Changing the "SMS" is very quick and easy.

This machine is manufactured in two versions to operate tape hole pitch 12,7 mm (90.OL12) or 15 mm (90.OL14)

If power feed is 110 V codes are:

90.OL11 for TAPE HOLE PITCH 12,7 mm
and 90.OL13 FOR TAPE HOLE PITCH 15 mm

LEAD Ø: 0,4-1 MM
PRODUCTION: 6000 P/H

SMS

DIE ASSEMBLIES FOR TP/R-PR-AS

THEY SHALL ALWAYS BE ORDERED WITH THE TP/R-PR-AS MACHINE
(THEY ARE NOT INCLUDED IN THE MACHINE'S PRICE)



SMS/1
93.0001
DOUBLE KINK/
STAND
OFF – LOCK IN

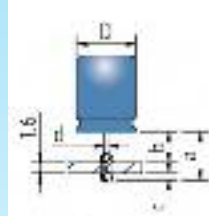

	MM			IN		
	min	max	fix	min	max	fix
a	6	13		.236	.511	
b	3	10		.118	.393	
c			1,4			.055
d	0,4	0,8		.015	.031	
D	1	10		.039	.393	



SMS/2
93.0002
STAND OFF



	MM			IN		
	min	max	fix	min	max	fix
a	6	13		.236	.511	
b	3	10		.118	.393	
c			1,4			.055
d	0,4	0,8		.015	.031	
D	1	10		.039	.393	



SMS/3
93.0003
BODY LOCKED ON P. C.
BOARD

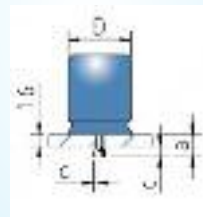

	MM			IN		
	min	max	fix	min	max	fix
a			3			.118
c			1,4			.055
d*	0,4	0,8		.015	.031	
D	1	10		.039	.393	



SMS/4
93.0004
STRAIGHT CUT

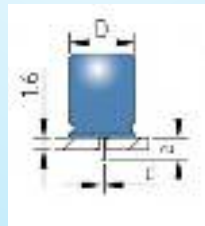

	MM			IN		
	min	max	fix	min	max	fix
a	3	10		.118	.393	
d	0,4	0,8		.015	.031	
D	1	10		.039	.393	



SMS/5
93.0005
POLARITY

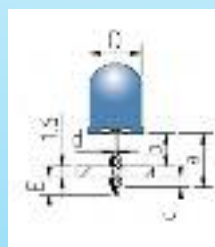

	MM			IN		
	min	max	fix	min	max	fix
a	6	13		.236	.511	
b	3	10		.118	.393	
c			1,4			.055
d*	0,4	0,8		.015	.031	
D	1	10		.039	.393	
E*			2,2			.086

*: QUOTA TO BE COMUNICATED AT ORDER



SMS/6
93.0006
90° BENDING

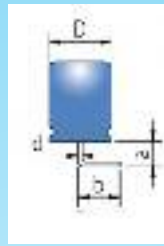

	MM			IN		
	min	max	fix	min	max	fix
a	3	8		.118	.314	
b*			6			.236
d*	0,4	0,8		.015	.031	
D*	1	6		.039	.236	



SMS/7
93.0007
SMD
PLACEMENT

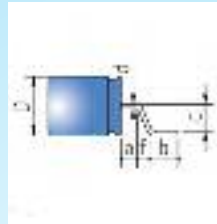

	MM			IN		
	min	max	fix	min	max	fix
a	2,5	8		.098	.314	
b*			2			.078
c*			2,5			.098
d*	0,4	0,8		.015	.031	
D*	1	10		.039	.393	
f*			1			.039



SMS/8
93.0008
CENTRE LEAD SPREAD
1,27mm AND CUT
FOR TO-92

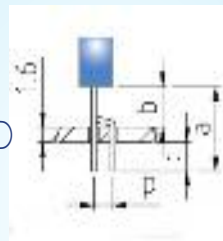

	MM			IN		
	min	max	fix	min	max	fix
a	6	9		.236	.354	
b	3	6		.118	.236	
c			1,4			.055
p*			1,27			.05



SMS/10
93.0010
CENTRE LEAD SPREAD
1,27mm LOCK IN AND
CUT TO-92

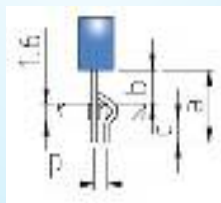

	MM			IN		
	min	max	fix	min	max	fix
a	6	9		.236	.354	
b	3	6		.118	.236	
c			1,4			.055
p*			1,27			.05



SMS/11
93.0011
CENTRE LEAD SPREAD
1,27mm AND 3
LEADS LOCK TO-92

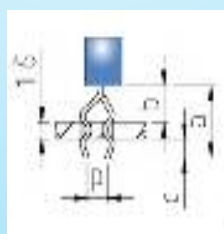

	MM			IN		
	min	max	fix	min	max	fix
a	6	9		.236	.354	
b	3	6		.118	.236	
c			1,4			.055
p*			1,27			.05

*: QUOTA.TO BE COMUNICATED AT ORDER